

## m2r Throughbolt, stainless steel A4/316



### Features

- European Technical Approval Option 7 for non-cracked concrete
- Torque controlled expansion
- Stainless steel A4/316
- Pre installation or through fixing
- Outdoor applications



### Applications

façades, cable trays, railings, steel constructions, machines, high-racks, profiles

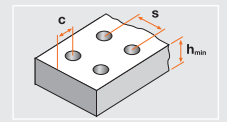
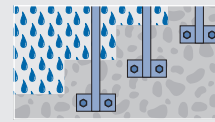
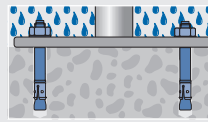

### Technical Data

	Concrete C20/25 tension load (kN)	Concrete C20/25 shear load (kN)	Bending moment (Nm)	Distance betw. anchors mm	Edge distance mm	Min. distance betw. anchors/at edge distance mm	Min. edge distance/at distance betw. anchors mm	Minimum thickness of concrete member mm	Installation torque (Nm)	Wrench size
				s	c	$S_{min}/c$	$C_{min}/s$	$h_{min}$	$T_{inst}$	SW
M6	3.6	3.9	6.4	120	60	40/70	40/80	100	6.5	10
M8	5.7	7.1	16.1	150	75	50/90	50/100	100	25	13
M10	7.6	11.2	32.2	174	87	60/115	60/120	120	35	17
M12	11.9	16.3	56.4	204	102	75/150	100/150	140	125	19
M16	14.3	30.3	142.8	240	120	100/190	130/190	160	140	24

The partial safety factors of the resistances as well as a partial safety factor of the load of  $\gamma_F = 1.4$  are considered / The technical data is only valid for single fixings without consideration of edge and anchor distances / Only valid for setting depths according to approval / 1 kN  $\approx$  100 kg

### Installation

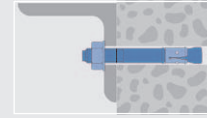
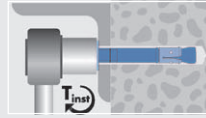
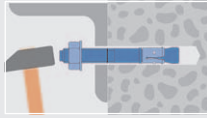
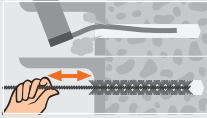
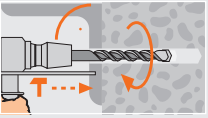

### m2r Throughbolt with washer DIN 125A, stainless steel A4/316



Article code	Plug and drill $\varnothing$ mm	Length mm	Drilling depth mm	Usable length mm	Effective anchorage depth mm	Box content	Outer carton	Quantity per pallet
	$d_{nom} = d_0$	L	$h_0$	$t_{fix}$	$h_{ef}$	FS	SK	
<sup>1)</sup> 3300605	6	50	50	5	30	100 21	900 22	54000
3300606	6	65	60	10	40	100 21	900 22	54000
<sup>1)</sup> 3300805	8	50	45	5	27	100 21	900 22	54000
<sup>1)</sup> 3300806	8	60	50	10	30	100 21	900 22	54000
3300808	8	80	65	10	50	100 41	300 12	18000
3300885	8	85	65	15	50	100 41	300 12	18000
3300809	8	95	65	25	50	100 51	300 22	18000
3300811	8	115	65	45	50	100 51	300 22	18000
<sup>1)</sup> 3301006	10	60	55	5	33	100 41	300 12	18000
<sup>1)</sup> 3301007	10	70	60	10	35	100 51	300 22	18000
3301009	10	95	80	15	58	100 51	300 22	18000
3301011	10	110	80	30	58	50 51	150 22	9000
3301012	10	125	80	45	58	50 51	150 22	9000
3301014	10	140	80	60	58	50 51	150 22	9000
3301016	10	160	80	80	58	50 51	150 22	9000
3301018	10	180	80	100	58	25 51	75 22	4500
<sup>1)</sup> 3301208	12	80	70	5	49	50 41	150 12	9000
3301211	12	110	90	15	68	50 51	150 22	9000
3301212	12	125	90	30	68	50 51	150 22	9000
3301214	12	145	90	50	68	25 41	75 12	4500
3301216	12	165	90	70	68	50 51	150 22	9000
3301218	12	185	90	90	68	50 51	150 22	9000
<sup>1)</sup> 3301611	16	115	100	10	70	25 51	75 22	3600
3301613	16	130	110	15	80	25 51	75 22	3600
3301614	16	145	110	30	80	25 51	75 22	3600
3301616	16	160	110	45	80	25 51	75 22	3600
3301618	16	180	110	65	80	25 51	75 22	3600

M20 on request

<sup>1)</sup> Not part of the approval

### m2r-C Throughbolt with big washer DIN 9021, stainless steel A4/316

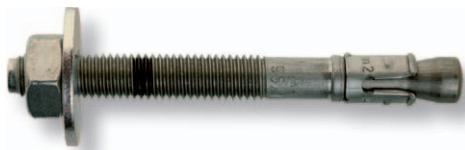

Article code	Plug and drill $\varnothing$ mm	Length mm	Drilling depth mm	Usable length mm	Effective anchorage depth mm	Box content	Outer carton	Quantity per pallet
	$d_{nom} = d_0$	L	$h_0$	$t_{fix}$	$h_{ef}$	FS	SK	
<sup>1)</sup> 3310806	8	60	50	10	30	100 41	300 12	18000
<sup>1)</sup> 3310808	8	80	65	10	50	100 51	300 22	18000
<sup>1)</sup> 3311007	10	70	60	10	35	100 51	300 22	18000
<sup>1)</sup> 3311009	10	95	80	15	58	50 51	150 22	9000

<sup>1)</sup> Not part of the approval